

PM – FITTING OUT THE DRIVER'S ROOM

PROJECT OWNER : GANIL

AREA: 58 m²

PROJECT : Study and project management mission for the development of the SPIRAL 2 control room

LOCALISATION : Caen (14)

Design study - Ergonomics - FOH

DATE : 2015

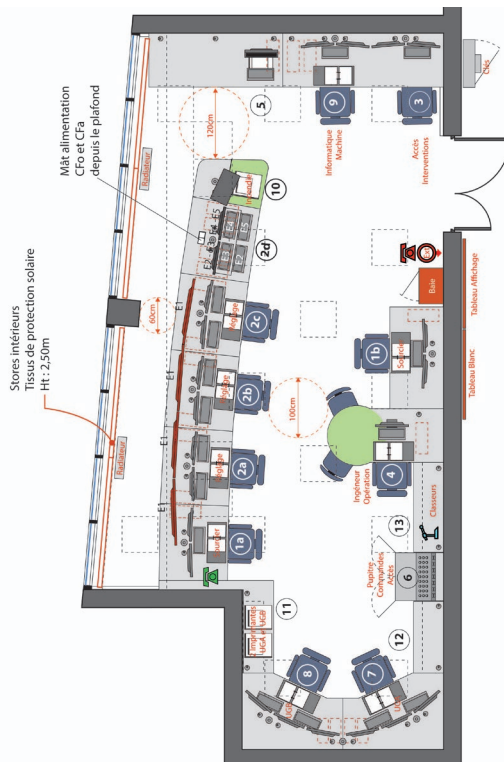

The collaborative and participative management of this project in the study phase was reinforced by the use of immersive 3D simulation tools such as the SAMSUNG GEAR VR headset or the HTC VIVE headset. This method and these tools enabled the future operators to discover, comment on and validate their future workstation.

As part of its SPIRAL 2 - Phase 1 particle accelerator extension project, GANIL needed to equip itself with a remote control station.

The study and design had to achieve the objectives of functionality (integration of the necessary equipment), ergonomics and design.

The project management mission consisted of coordinating the manufacture in the workshop and the installation on site.